



The ultimate in  
pneumatic performance

# Contents

<b>Inline Centrifugal Fans</b> .....	<b>3</b>
<b>Full Centrifugal Fans</b> .....	<b>4</b>
<b>High-speed Centrifugal Fans</b> .....	<b>5</b>
<b>Low-speed Centrifugal Fans</b> .....	<b>6</b>
<b>TurboFan</b> .....	<b>7</b>
<b>Booster Fan</b> .....	<b>8</b>
<b>Rover Aeration Fan Cart</b> .....	<b>9</b>
<b>UFO Aeration System</b> .....	<b>10</b>
<b>Portal Grain Door Insert</b> .....	<b>12</b>
<b>Aeration Socks &amp; Clamps</b> .....	<b>13</b>
<b>Aeration Transitions</b> .....	<b>14</b>



SMART WARRANTY OWNERSHIP PROTECTION

## No questions asked..

The S3 Smart Warranty Ownership Protection Program (SWOP) guarantees responsive product replacement for two full years. SWOP is applicable to any manufacturing defect or product failure. You have the assurance of no waiting, no worries, no questions... just SWOP it out. It really is that simple.

## More air, less maintenance...

S3 Air Systems offers the widest range of aeration fans and fan options on the market. Our line-up of fans are all crafted with a durable steel body. The steel inlets are finished with our signature powder coat finish, with zinc-plated screens. Fan components have been engineered to be extremely lightweight and durable for quicker run-up time and lower amp draw. All of our fan rotor assemblies are crafted from aluminum and dynamically balanced for ultra-smooth, efficient performance.

Larger starter boxes enable much easier electrical hook-up, most are bin-sense controller-ready, CSA approved, and come standard with the ultra-fast protection offered by S3's SWOP warranty program. S3 Air System's commitment to high volumes of inventory ensure lightning-fast order fulfillment and warranty response times.



SWOP

SMART WARRANTY OWNERSHIP PROTECTION

# Inline Centrifugal Fans



With a straight-through airflow path, Inline fans are compact with a straight-forward installation. They deliver high-efficiency, high-volume airflow in moderate pressure applications.

The S3 Air Systems Inline Centrifugal Fan utilizes a centrifugal rotor and inlet specifically designed and balanced for smooth, quiet, and efficient operation.

The fan incorporates the following features:

- 100% CSA Certified fan and components.
- Heavy gauge steel housing with platform feet.
- Spun bell Inlet for smooth air intake and efficiency.
- Air straighteners to efficiently align the air stream.
- Aluminum fan rotor for a light weight efficient design, corrosion resistance, and quick starts with lower amp draw.
- Powder coated body and zinc-plated screen for long life.
- Internal motor that is 100% CSA Certified and thermally protected.
- Weather-tight control enclosure.

## Inline Centrifugal Fan specifications

Airflow (CFM) @ 3450 RPM

Static Pressure (inches)	3 HP	5 HP	7½ HP	10 HP	15 HP
4	3030	4790	6345	7410	7900
6	2260	4150	5550	6930	7350
8		3180	4425	6210	6700
10			2280	5120	5800
12				3700	4200



# Full Centrifugal Fans



Full Centrifugal Aeration fans provide high airflow to counter the higher back pressures of larger grain bins or silos with a significant amount of grain. They can distribute air evenly throughout the grain mass and provide good airflow for temperature and moisture control.

The S3 Air Systems Full-speed Centrifugal Aeration Fan utilizes a centrifugal rotor which spins at a nominal 3450 rpm and incorporates the following features:

- 100% CSA Certified fan and components.
- Heavy gauge steel housing with motor-mount base and feet.
- Heavy duty support over center of gravity for easy and strong suspended install style.
- Spun bell intake for smooth air intake and high efficiency.
- Fan housing has tapered exhaust for easy insert and proper fit.
- Aluminum fan rotor for a light weight efficient design, corrosion resistance, and quick starts with lower amp draw.
- Powder coated body and zinc-plated screen for long life.
- Internal motor that is 100% CSA Certified and thermally protected.
- Weather-tight control enclosure.

Fans come standard Bin Sense ready, with the exception of 3 & 5 HP models, which can be equipped upon request.



## Full Centrifugal Fan specifications

Static Pressure (inches)	Airflow (CFM) @ 3450 RPM			
	3 HP	5 HP	7½ HP	10 HP
4	3060	4100	5325	6400
6	2690	3520	4820	5800
8	2170	3060	4280	5000
10	1300	2470	3510	4200
12		1760	2300	3600



# High-speed Centrifugal Fans



High-speed Centrifugal Aeration Fans provide maximum airflow in larger grain bins or silos particularly when there is a need for rapid cooling or drying. They can handle higher static pressures and are effective for pushing air through longer duct systems or resisting backpressure from dense grain masses.

The S3 Air Systems High-speed Centrifugal fan utilizes a centrifugal rotor spinning at a nominal 3550 rpm and incorporates the following features:

- 100% CSA Certified fan and components.
- Heavy gauge steel housing with motor-mount base and feet.
- Heavy duty support over center of gravity for easy and strong suspended install style.
- Spun bell intake for smooth air intake and high efficiency.
- Aluminum fan rotor for a light weight efficient design, corrosion resistance, and quick starts with lower amp draw.
- Powder coated body and zinc-plated screen for long life.
- Internal motor that is 100% CSA Certified and thermally protected.
- Weather-tight control enclosure.

## High-speed Centrifugal Fan specifications

Static Pressure (inches)	Airflow (CFM) @ 3550 RPM			
	20 HP	25 HP	30 HP	40 HP
2			12024	15240
4	8261	9546	11529	14757
6	7870	9059	11044	14245
9	7235	8465	10320	13414
12	6538	7939	9580	12495
15	5773	7183	8797	11465
18	4913	6378	7936	10286
22	3395	5293	6545	8341
26		3491	4233	
27		556		



# Low-speed Centrifugal Fans



Low-speed Centrifugal Fans are most effective where gentle and continuous airflow is required at lower pressures or where a gentler airflow is preferred to avoid excessive grain movement or damage. They can provide more uniform aeration, allowing for better moisture equilibrium and temperature control in the grain mass.

The Low-speed Centrifugal Aeration Fan has been designed for applications that require extremely high flow at low pressure. This fan utilizes a centrifugal rotor spinning at a nominal 1750 rpm and incorporates the following features:

- 100% CSA Certified fan and components.
- Heavy gauge steel housing with platform feet.
- Heavy duty support over center of gravity for easy and strong suspended install style.
- Spun bell intake for smooth air intake and high efficiency.
- Aluminum fan rotor for a light weight efficient design, corrosion resistance, and quick starts with lower amp draw.
- Powder coated body and zinc-plated screen for long life.
- Internal motor that is 100% CSA Certified and thermally protected.
- Weather-tight control enclosure.

## Low-speed Centrifugal Fan specifications

Static Press. (inches)	Airflow (CFM) @ 1750 RPM				
	10 HP	15 HP	20 HP	25 HP	30 HP
1	13500	17000	20750	23500	25100
2	12800	16200	20000	22500	24300
3	11850	15250	19000	21350	23300
4	10700	14400	18100	20250	22250
5	9400	13400	17000	19100	21000
6	8200	12100	15500	18000	19750
7	7200	10500	14000	17000	18600





The TurboFan® combines the features and ease-of use and high-efficiency benefits of the standard Inline centrifugal fan, with an enhanced design that provides higher CFM at the same static pressure –with no offsetting increase in horsepower requirements. The TurboFan® delivers high-efficiency, high-volume airflow in moderate pressure applications. It incorporates the following features:

- 100% CSA Certified fan and components.
- Heavy gauge steel housing with platform feet.
- Spun bell intake for smooth air intake and high efficiency.
- Air straighteners to efficiently align the air stream.
- Aluminum fan rotor for a light weight efficient design, corrosion resistance, and quick starts with lower amp draw.
- Powder coated body and zinc-plated screen for long life.
- Internal motor that is 100% CSA Certified and thermally protected.
- Weather-tight control enclosure.

## TurboFan® specifications

Static Pressure (inches)	Airflow (CFM) @ 3450 RPM		
	3 HP	5 HP	7½ HP
3	3850		
4	3700		6000
5	3250	4500	5700
6	2800	4250	5400
7	2400	3600	5100
8	1250	3300	4700
9		2200	4100
10			3250



# BOOSTERFAN<sup>®</sup>

Pair with an existing inline fan and get double the air pressure and maximum CFM output.



The BoosterFan<sup>®</sup> provides fast, portable enhancement to your existing inline aeration fan. The BoosterFan<sup>™</sup> provides the ability to quickly adapt to a change in bin conditions that require higher static pressures to maintain airflow.

Suitable for either temporary or long-term drying conditions, the BoosterFan<sup>®</sup> eliminates the cost and inefficiency of removing and replacing the existing inline fan with one of higher horsepower. Simply clamp the BoosterFan<sup>®</sup> to the existing inline aeration fan, and double the static pressure output and increase the airflow (CFM).

- 100% CSA Certified fan and components.
- Heavy gauge steel housing with platform feet.
- Spun bell intake for smooth air intake and high efficiency.
- Air straighteners to efficiently align the air stream.
- Aluminum fan rotor for a light weight efficient design, corrosion resistance, and quick starts with lower amp draw.
- Powder coated body and zinc-plated screen for long life.
- Internal motor that is 100% CSA Certified and thermally protected.
- Weather-tight control enclosure.

## BoosterFan<sup>®</sup> specifications

Static Pressure (inches)	Airflow (CFM) @ 3450 RPM		
	3 HP	5 HP	7½ HP
4	3200	5050	6700
6	2500	4550	6100
8	1850	4325	5850
10	1150	4050	4700
12		3400	4200
14		3025	3650
16		2650	3150
18			2400
20			1575





Make your aeration equipment truly portable.



### 3 bins, one fan—no problem.

The Rover® fan cart gives you flexibility to move your aeration fan to where you need it the most. Hook up to an ATV, a garden tractor, or simply move by hand.

- Load capacity of 350 lbs.
- Powder-coated steel construction.
- Simple assembly.

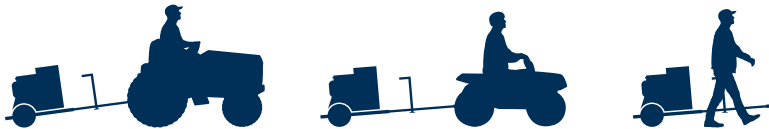

Use only small engine vehicles such as garden tractors or all-terrain vehicles to tow the Rover, or transport unit by hand. The Rover is not designed to be towed by road vehicles.

Never transport faster than the terrain conditions will allow you to do safely. The maximum tow speed is 5km/hr. The Rover is designed to carry a load up to 350 lbs. Do not exceed this value or failure could occur.

### Designed to fit:

**Note: The Rover® fan cart is designed to work with the following S3 Air Systems aeration fan systems. Use appropriate fasteners (not included) to mount fan to cart.**

Inline fan 3 HP
Inline fan 5 HP
Inline fan 7.5 HP
Inline fan 10 HP
Inline fan 15 HP
Full Centrifugal 3 HP
Full Centrifugal 5 HP
Full Centrifugal 7.5 HP
Full Centrifugal 10 HP



Pictured with Full Centrifugal fan in operational position.



Pictured with TurboFan® in operational position.





Portable, modular aeration with higher airflow.

The UFO Aeration® System introduces an all-new level of mobility and efficiency to grain bin aeration. With a completely modular design the UFO offers the flexibility to be set up and used where and when needed. All steel, powder-coated base and legs with durable, lightweight stage components that weigh less than 6 lbs each.

UFO Aeration is recommended for hopper bottom bins that are less than 30ft in diameter and have an overall height of less than 30ft (from bottom of hopper cone to top of side wall). Accommodates loading / unloading augers up to 10" in diameter, and is excellent for all grain types. Not compatible with fertilizer or supplemental heat.

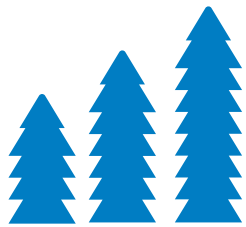
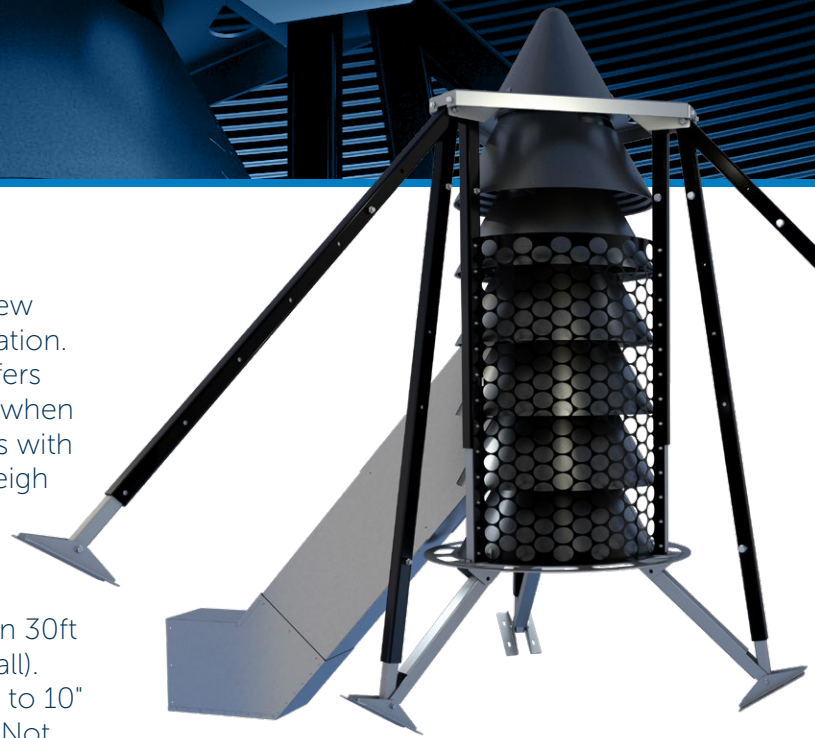

Available in three standard size configurations, 4-stage, 6-stage and 8-stage. Easily add or remove stages for optimum aeration flexibility.

### UFO Aeration specifications

	Description	Dimension
<b>A</b>	Nose cone diameter	17 5/8"
<b>B</b>	Nose cone rise	16 1/2"
<b>C</b>	Stage diameter	27"
<b>D</b>	Stage rise	9 1/4"
<b>E</b>	Base plate diameter	36"
<b>F</b>	Base plate to peak rise (with 6 stages and nose cone)	72"

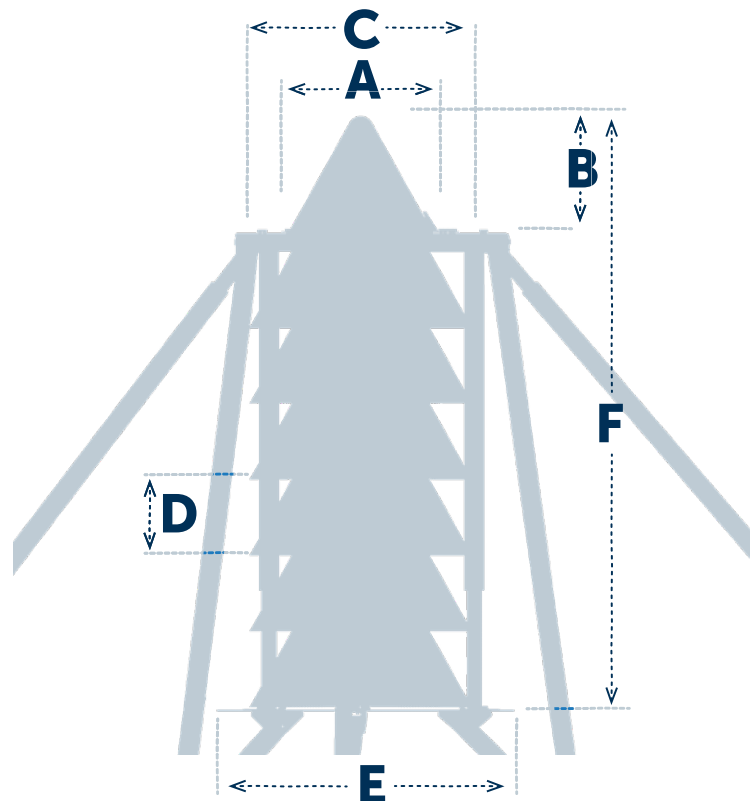

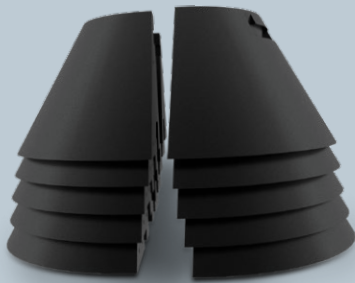

Nestable parts for easy transport and storage.



All components fit through 18" x 18" hopper access openings.

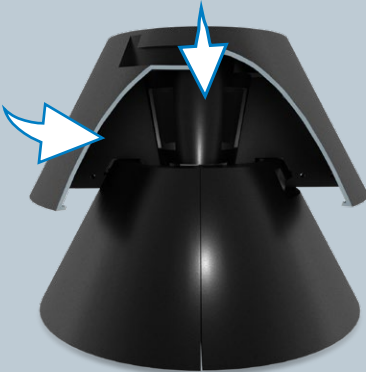

2-part stages bolt together and lock into place.

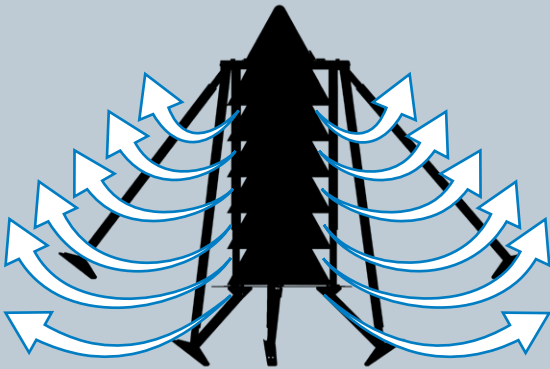

More than 4 times the airflow of traditional systems.

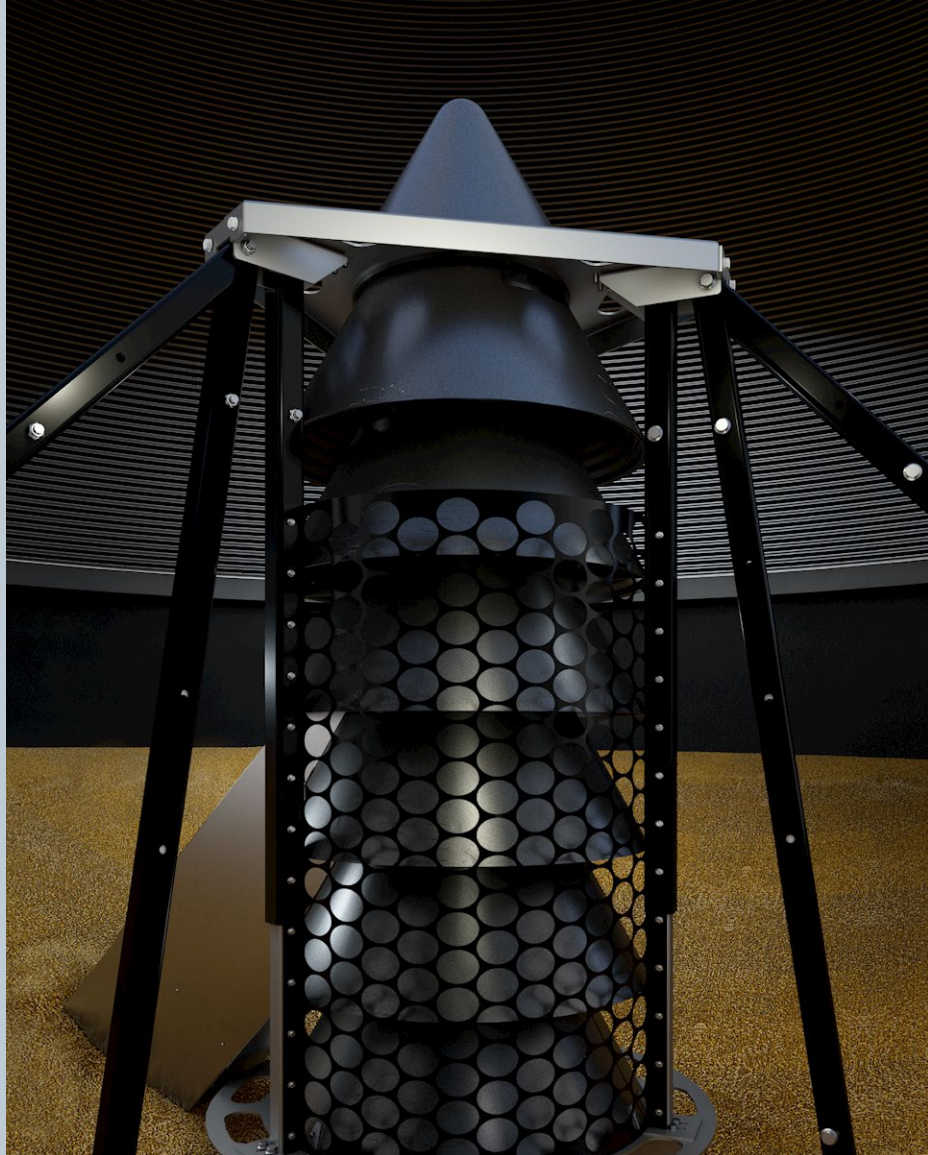



The Portal® bin door insert eliminates the need to insert an auger into a narrow bin-door auger port when unloading. Other benefits include:

- No stuck augers in the auger port.
- No grain spillage from pulling the auger out of the bin while the bin is still partial or fully loaded.
- Never needing to start the auger under load.
- The auger is allowed to clean out by stopping the flow to it while running.
- Large diameter augers which would not traditionally fit into some bin's auger ports can be used with the Portal.
- Certain commodities or situations call for a restricted flow to the auger which is possible with the adjustable slide gate.
- The Portal can be sealed to prevent leaks even when running an aeration fan on the bin.
- Flow accommodates 12" auger capacity.
- Not recommended on bins larger than 19' diameter and 7 tiers high.



With optional Standard Chute (36-117502)



With optional Vac Chute (36-117529)

## Portal® kits & accessories

Note: for kit selection and parts details please see the Portal® User Manual available online at: [S3AirSystems.com/products/accessories/](http://S3AirSystems.com/products/accessories/)

Configurations by bin type	Part Number
Westeel bin configuration 1	36-117512
Westeel bin configuration 2	36-117513
Westeel bin configuration 3	36-117514
Twister bin configuration 1	36-117515
Twister bin configuration 2	36-117515
Twister bin configuration 3	36-117517
Butler bin configuration 1	36-117518
Butler bin configuration 2	36-117519
Butler bin configuration 3	36-117520
Butler bin configuration 4	36-117521
Customizable bin kit	36-117539

Accessories	Part Number
Chute –standard	36-117502
Chute –for grain vacs	36-117529

# Aeration Socks & Clamps

Experience maximum mobility, adaptability and convenience with S3 Air Systems® Aeration Socks.

Aeration Socks allow for fast fan-to-bin connection without having to lift and mount the fan to the aeration port. With the platform and portability of a Rover® fan cart (see page 9), a single fan can be used to efficiently dry several bins.

## S3 Air Systems Aeration Socks specifications



Note the following:

- Standard sock length is 12' with more sizes and lengths are available by request.
- Socks with round ends come complete with a quick strap buckle for Inline Fans.
- Socks with rectangular ends require a clamp selection for full centrifugal fans.

### End type & size configurations

Fan side	Bin side	Part Number
● 18" O.D.	■ 9" X 14"	3005-00-0003
● 18" O.D.	● 18" O.D.	3005-00-0004
● 18" O.D.	● 24" O.D.	3005-00-0005
● 24" O.D.	■ 9" X 14"	3005-00-0006
● 24" O.D.	● 18" O.D.	3005-00-0007
● 24" O.D.	● 24" O.D.	3005-00-0008
● 28" O.D.	■ 9" X 14"	3005-00-0009
● 28" O.D.	● 24" O.D.	3005-00-0010
■ 9" X 14"	■ 9" X 14"	3005-00-0011
■ 9" X 14"	● 18" O.D.	3005-00-0012
■ 9" X 14"	● 24" O.D.	3005-00-0013
● 28" O.D.	● 28" O.D.	3005-00-0014
■ 12" X 17"	■ 12" X 17"	3005-00-0015



Accessories	Part Number
 Sock Clamp (screwed) for 9" x 14" fan outlet (hardware included)	6190-00-0022
 Sock Clamp (bolted) for 9" x 14" fan outlet (hardware included)	6190-00-0023

# Aeration Transitions

S3 AirSystems™ transitions are well designed to ensure a proper, durable fit between the Aeration Fan and the Bin.

## Aeration transitions

Standard sizes shown. Other sizes are available on request.

	Fan side	Bin side	Part Number
	18" O.D.	9" X 14"	18-115500-1
	18" O.D.	24" O.D.	18-115501-1
	24" O.D.	9" X 14"	18-115502-1
	24" O.D.	12" X 17"	18-115510-1
	24" O.D.	18" O.D.	18-115503-1
	24" O.D.	28" O.D.	18-115508-1
	28" O.D.	12" X 17"	18-115511-1
	28" O.D.	18" O.D.	18-115557-1
	28" O.D.	24" O.D.	18-115509-1



18-115500-1 enlarged



18-115557-1 enlarged

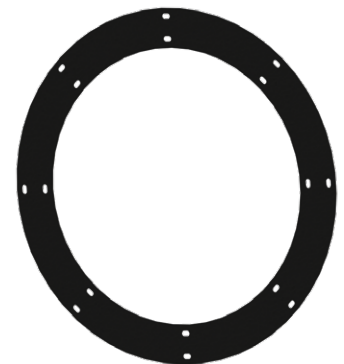

18-115508-1 enlarged

	Fan side	Bin side	Part Number
	9" x 14"	18" O.D.	18-115504-1
	9" x 14"	24" O.D.	18-115505-1
	9" x 14"	28" O.D.	18-115506-1
	12" x 17"	18" O.D.	18-117284-1
	12" x 17"	24" O.D.	18-115513-1
	9" x 14"	12" X 17"	18-115512
	12" x 17"	9" x 14"	18-115507



**18-115506-1 enlarged**

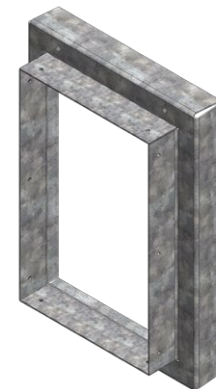

**18-115512 enlarged**

### Low speed fan transitions

Description	Transition outlet	Part Number
 10 HP	9" X 14"	18-115500-1
 20 HP	24" O.D.	18-115501-1
 25 HP	9" X 14"	18-115502-1
 30 HP	12" X 17"	18-115510-1



**18-115510-1 enlarged**

Custom sizes are available upon request.



## AIR SYSTEMS

Innovation • Precision • Sustainability



Scan to learn more about our products



### S3 Air Systems

605 & 732 North Railway St E  
P.O. Box 1212  
Swift Current SK S9H 3X4  
Canada

Toll Free: 844-441-2020  
Phone: 306-773-0646  
Fax: 306-773-9318



### S3 AWS Airbar

3890 Wellington St  
Mitchell ON N0K 1N0  
Canada

Toll Free: 877-348-0066  
Phone: 519-348-0066  
Fax: 519-348-0061



### S3 Manufacturing

**South Building**  
2180 Oman Drive  
P.O. Box 1780  
Swift Current SK S9H 4J8  
Canada

Toll Free: 844-441-3030  
Phone: 306-773-0646  
Fax: 306-773-9318



### S3 Wireform

**North Building**  
2180 Oman Drive  
P.O. Box 1207  
Swift Current SK S9H 3X4  
Canada

Toll Free: 844-441-1010  
Phone: 306-773-0644  
Fax: 306-773-1188



### S3 Delta Harrows

800 South Fremont St  
Shenandoah IA 51601  
USA

Toll Free: 877-874-3020  
Phone: 712-246-3020  
Fax: 712-246-3022



### S3 PowerPin

598 Second Street East, Fort  
Qu'Appelle SK SOG 1S0  
Canada

Toll Free: 877-348-0066  
Phone: 306-332-5034  
Fax: 519-348-5035



### S3 Brandworx

**North Building**  
2180 Oman Drive  
P.O. Box 1780  
Swift Current SK S9H 4J8  
Canada

Phone: 306-773-0647



Industrial product development solutions.

[S3group ltd.com](http://S3group ltd.com)

P.O. Box 39  
Suite 1670  
1150 Central Avenue N  
Swift Current SK S9H 3V5  
Canada

Phone: 306-773-0644  
Fax: 306-773-1188